

## Wireless Presenter User Manual

### N95 Plus BLE

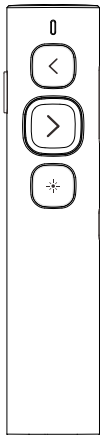

Be sure to read this user manual carefully before using the wireless presenter and keep it for future reference.

## WARNING

This product can generate laser beam. DO NOT STARE INTO BEAM OR EXPOSE USERS OF TELESCOPIC OPTICS. Do not shine the laser beam on people's or animal's eyes to avoid eye damage! Do not give this product to children as a toy!

Warning label for red laser product:



Warning label for green laser product:



## **I. Safety Precautions**

1. Use this product correctly according to this manual.
2. This product is for professional use only. Children under 14 years of age are strictly prohibited from using it.
3. Do not point the laser beam at human eyes, including via mirror reflections.
4. Do not observe the laser beam with naked eyes or using optical instruments (e.g., telescopes or magnifying glasses).
5. Avoid pointing the laser beam arbitrarily at various optical reflective surfaces.
6. Do not intentionally or casually irradiate people.
7. This product contains a built-in lithium battery. If the battery swells, stop using it.
8. Do not place the product in high-temperature environments or throw it into fire.
9. Do not immerse this product in

water or any other liquid.

10. Do not disassemble, impact, or crush the product without authorization. If the product malfunctions, contact Norwii after-sales support.

## **II. Operation system**

Supports Windows 10/11 and macOS 10.15 and later. On Android and Linux systems, only the laser and page up/down functions are supported.

## **III. Package contents**

1. Wireless presenter \* 1 (USB receiver stored inside the wireless presenter)
2. User Manual \* 1

## **IV. Specifications**

### **Transmitter**

Technology: Radio frequency

Frequency: 2.4GHz

Control Distance: 100 meters

Laser Power: see warning label on

the product

Laser Distance: >200m

Wavelength: Red 640-660nm

Wavelength: Green 495-545nm

Battery capacity: 300mAh lithium battery

Working Voltage: 3.6-4.2V

Charging Voltage: 5V

Dimension: 132.5\*29\*12.5mm

Weight: 31g

### **USB-A and USB-C receiver**

Working Voltage: 4.5-5.5V

Dimension: 36.3\*15.7\*3.9mm

Weight: 3.5g

### **USB-C receiver**

Working Voltage: 4.5-5.5V

Dimension: 36.3\*15.7\*3.9mm

Weight: 3.5g

### **USB-A receiver**

Working Voltage: 4.5-5.5V

Dimension: 36.3\*15.7\*3.9mm

Weight: 3.5g

## **V. Connection Methods**

The Wireless Presenter has two

connection methods: one is to connect to the computer via a USB receiver, which supports both USB-A and USB-C (also known as Type-C) interfaces; the other is to connect to the computer via Bluetooth.

### **1. The wireless presenter can be connected to a computer via a USB receiver.**

There are 3 types of USB receivers for this product, the first one is a dual-head receiver, which contains two connectors, USB-A and USB-C, and has no USB drive; The second is a USB-A connector, which may have an internal USB drive; The third type is the USB-C connector, which may have a USB drive inside. There is only one type of receiver in a package, either a dual-head receiver, a USB-C receiver, or a USB-A receiver, not more than two USB receivers at the same time. Which specific type of USB receiver it is depends on the choice made at

the time of purchase.

1) Turn on the wireless presenter power switch and remove the USB receiver from the end of the wireless presenter.

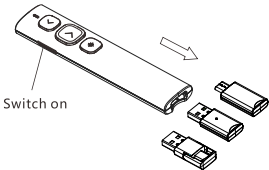

2) Plug the USB receiver into the USB port of your computer, 'New Hardware Found' will be displayed on the lower right corner of the computer desktop, and Windows will automatically install the driver. When Windows displays 'New Hardware Installed and Ready', it means the USB receiver installation is complete, and then you can control your computer through the wireless presenter.

**2. Bluetooth connection on**

**Windows computer.**

1) On the computer, turn on the Bluetooth switch, click Add Device, and select Bluetooth as the device type.

2) Turn off the power of the wireless presenter, press and hold the wireless presenter's page up key, turn on the wireless presenter's power switch, then release the wireless presenter's page up key. At this time, the wireless presenter's LED will flash, indicating that it is waiting for pairing in the following 3 minutes.

3) On the computer, find the "Norwii N95 Plus BLE" in the "Add device", click connect, and at the same time, the presenter indicator light is off, and display "Norwii N95 Plus BLE" connected in "Bluetooth & device". The presenter can now control the computer.

### **3. Bluetooth connection on macOS computer.**

1) On the computer, select Bluetooth in the computer System Settings and turn on the Bluetooth switch.

2) Turn off the power of the wireless presenter, press and hold the wireless presenter's page up key, turn on the wireless presenter's power switch, then release the wireless presenter's page up key. At this time, the wireless presenter's LED will flash, indicating that it was waiting for pairing in the following 3 minutes.

3) On the computer, find the "Norwii N95 Plus BLE" on "Nearby Devices", click connect, and at the same time, the presenter indicator light is off, and display "Norwii N95 Plus BLE" connected in "My Computer". The presenter can now control the

computer.

#### **4. Priority of USB receiver and Bluetooth connection.**

USB receivers have higher priority than computer Bluetooth. After connecting the wireless presenter to the computer via Bluetooth, plug in the USB receiver, and the wireless presenter will disconnect from the computer via Bluetooth and establish a connection with the USB receiver. Pull out the USB receiver, and the wireless presenter will automatically connect to the computer via Bluetooth. The wireless presenter cannot be paired with computer via Bluetooth when the USB receiver is plugged in.

#### **5. Bluetooth wireless presenter and device reconnection.**

The wireless presenter can store IDs for the 7 most recently connected devices (computers, iPads, phones, etc.). The USB receiver is not included in these 7 devices. After turning on the

wireless presenter, the first device that sends a reconnection request with a signal strength greater than -10 dBm will connect to the wireless presenter.

For users: If a computer is among the 7 most recently connected devices, turning the wireless presenter off and then back on within 5 meters (16 feet) of the computer will automatically reconnect the wireless presenter to the computer.

### **6. To clear the saved device IDs from the wireless presenter:**

- 1) Turn off the power switch of the wireless presenter.
- 2) Press and hold the laser key (for the N20 BLE, press the Tab key; for some products without a laser key, press the Pointer key).
- 3) Turn on the power switch.
- 4) Release the key once the LED blinks.

The blinking LED indicates that the wireless presenter has cleared all

## The Professional Presenter

---

saved device IDs and has entered Bluetooth pairing mode. Users can perform Bluetooth pairing within the next 3 minutes.

### VI. Bluetooth connectivity

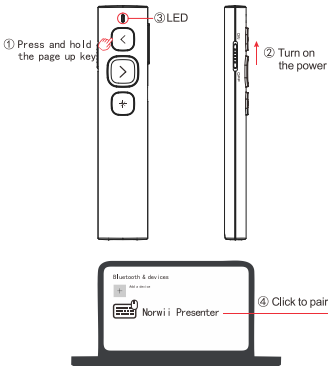

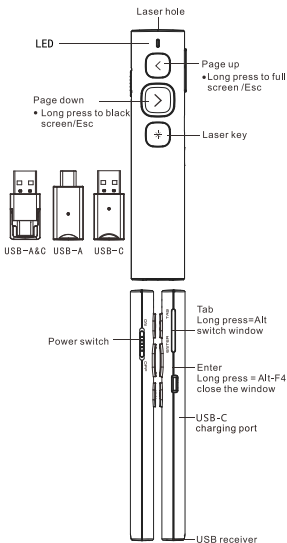

## VII. Function map





Attention: When using this product, please change your Input Method Editors (IME) to English input mode.

## VIII. Function Description

1. Power switch: push up to "ON" to turn on the presenter, push down to "OFF" to turn off the presenter.
2. Page up key : click to page up, long press to play slides from the current page. Long press again to end slide show.
3. Page down key : click to page down, long press to enter black screen, long press again to exit black screen.
4. Physical laser key : Press and hold to turn on the physical laser beam, and release to turn off the physical laser beam.
5. Hyperlink operation: Press the "Tab" key to switch between hyperlinks on the page, and press the "Enter" key to open the hyperlink. Long press the 'Enter' key to execute Alt-F4 to close the current active window. When switching windows, press and hold the "Tab" key to execute the Alt Tab function to switch between open

windows. Release the button on the window that needs to be switched to switch to the desired window.

6. Function switching of the page up and down keys.

Long press  and  simultaneously to switch between the four modes.

1) By default, the page up and down keys on the Bluetooth wireless presenter correspond to the left and right arrow keys on the computer keyboard, which is suitable for PowerPoint, WPS, Prezi, and Keynote.



2) The first time you press and hold both the page up and down keys on the wireless presenter simultaneously, the function will switch to the Page Up and Page Down keys on the computer keyboard. This is suitable for image-viewing software.

PgUp

PgDn

3) The second time you press and hold both the page up and down keys simultaneously, the function will switch to the mouse scroll wheel function. This is suitable for some short-video apps and web browsers.



4) The third time you press and hold both the page up and down keys simultaneously, the function will switch to the up and down arrow keys on the computer keyboard. This is suitable for Word, Excel, and other applications.



5) The fourth time you press and hold both the page up and down keys simultaneously, the function will switch to the default left and right arrow keys on the computer

keyboard.



6) After switching the function, it will be automatically saved. When you restart the wireless presenter, you can continue to use the switched function.

7. The page up/down keys can be customized by Norwii Presenter software.

### **IX. Wireless presenter charging**

1. Low power indication.

The blue LED on the wireless presenter will flash slowly to remind the user to charge the presenter.

2. Charging the wireless presenter.

Connect one end of the USB cable to the computer USB interface and the other end to the USB-C interface of the wireless presenter.

When the wireless presenter charges, the red indicator light always lights up. When the red indicator light turns green, it indicates that the wireless presenter

## The Professional Presenter

---

is fully charged. If you have a USB-C interface handheld charger, it can also be used to charge the wireless presenter.

### 3. Charging time

The charging time varies depending on the power supply of the USB interface. Normally, charging can be completed after about 2 hours of charging.

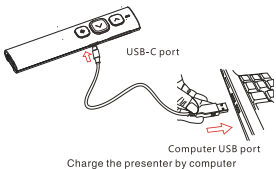

**X. In practice, some users have experienced the issue where PowerPoint and Keynote fail to turn pages in full-screen mode after enabling Full Keyboard Access.**

On Apple's iOS and iPadOS, when PowerPoint and Keynote are in full-screen mode, pressing the page up and page down keys on a wireless presenter does not turn the pages. Instead, the cursor focus moves between text areas. Please disable **\*\*Settings -> Accessibility -> Full Keyboard Access\*\***.

## **XI. FCC Statement**

Any Changes or modifications not expressly approved by the party responsible for compliance could void the user's authority to operate the equipment.

This device complies with part 15 of the FCC Rules. Operation is subject to the following two conditions:

1. This device may not cause

harmful interference, and

2. This device must accept any interference received, including interference that may cause undesired operation.

## **XII. FCC Radiation Exposure Statement**

1. This equipment complies with FCC radiation exposure limits set forth for an uncontrolled environment. This equipment should be installed and operated with minimum distance 20cm between the radiator & your body.

2. Note: This equipment has been tested and found to comply with the limits for a Class B digital device, pursuant to part 15 of the FCC Rules. These limits are designed to provide reasonable protection against harmful interference in a residential installation. This equipment generates, uses and can radiate radio frequency energy and, if not installed and used in

accordance with the instructions, may cause harmful interference to radio communications. However, there is no guarantee that interference will not occur in a particular installation. If this equipment does cause harmful interference to radio or television reception, which can be determined by turning the equipment off and on, the user is encouraged to try to correct the interference by one or more of the following measures:

- Reorient or relocate the receiving antenna.
- Increase the separation between the equipment and receiver.
- Connect the equipment into an outlet on a circuit different from that to which the receiver is connected.
- Consult the dealer or an experienced radio/TV technician for help.

### **XIII. Certifications**

CE, ROHS, FDA

FCCID: 2AXGRN95

### **XIV. Declaration of conformity**

This laser product complies with EN 50689:2021 and IEC/EN60825-1:2014/A11:2021. Complies with 21 CFR 1040.10 and 1040.11, except for deviations pursuant to Laser Notice No.50, dated June 24, 2007.

Shanghai Norwii Technology Co.,  
Ltd

Address: No.277 Jinfeng Road,  
Pudong New Area, Shanghai,  
201201, China

Tel: 86-21-51872080

Email: support@norwii.com